

Powrvent

Extract Ventilator



Overview

The PVE powered extract ventilator is designed for exhaust ventilation for various premises that require reasonable energy saving solutions and controlled ventilation systems. The range has excellent weathering characteristics and is contoured to provide the maximum performance. The PVE is suitable for either roof or wall mounting and designed for effective performance across a variety of demanding conditions through a wide range of sizes.

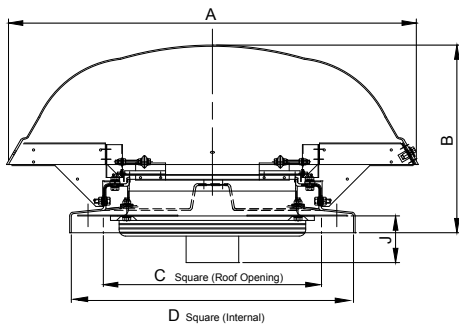

PVE

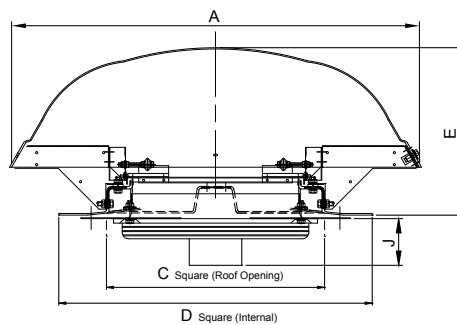

PVE Flat

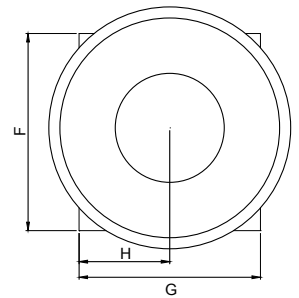

(For Extract volumes and technical specification please contact Powrmatic Ventilation)

PVE Dimensions

| Model | A | B | C | D | E | F | G | H | J | Weight |
|------------|------|-----|------|------|-----|------|------|-----|-----|--------|
| | mm | mm | mm | mm | mm | mm | mm | mm | mm | kg |
| PVE 40 ALL | 1000 | 460 | 535 | 692 | 415 | 815 | 750 | 375 | 106 | 27 |
| PVE 50 ALL | 1220 | 438 | 635 | 790 | 393 | 920 | 880 | 425 | 135 | 38 |
| PVE 60 ALL | 1370 | 498 | 790 | 945 | 453 | 1150 | 1085 | 543 | 198 | 51 |
| PVE 75 ALL | 1565 | 595 | 940 | 1095 | 550 | 1260 | 1155 | 578 | 199 | 76 |
| PVE 90 ALL | 1800 | 655 | 1170 | 1325 | 610 | 1545 | 1425 | 712 | 559 | 144 |

PVE Performance (900rpm)

| Model | Capacity m ³ /s | | Run Amps (A) | | dBA (1m) | |
|--------|----------------------------|------|--------------|------|----------|------|
| | 1 Ph | 3 Ph | 1 Ph | 3 Ph | 1 Ph | 3 Ph |
| PVE 40 | 0.72 | 0.72 | 0.5 | 0.3 | 65 | 65 |
| PVE 50 | 1.40 | 1.50 | 1.1 | 0.6 | 72 | 72 |
| PVE 60 | 2.46 | 2.49 | 2.9 | 1.3 | 79 | 80 |
| PVE 75 | N/A | 3.48 | N/A | 2.7 | N/A | 86 |
| PVE 90 | N/A | 6.27 | N/A | 4.2 | N/A | 98 |

PVE Performance (1400rpm)

| Model | Capacity m ³ /s | | Run Amps (A) | | dBA (1m) | |
|--------|----------------------------|------|--------------|------|----------|------|
| | 1 Ph | 3 Ph | 1 Ph | 3 Ph | 1 Ph | 3 Ph |
| PVE 40 | 1.20 | 1.19 | 1.3 | 0.7 | 76 | 76 |
| PVE 50 | 2.16 | 2.24 | 3.3 | 1.6 | 83 | 83 |
| PVE 60 | 3.77 | 3.77 | 8.3 | 3.1 | 90 | 90 |
| PVE 75 | N/A | 4.93 | N/A | 4.4 | N/A | 94 |
| PVE 90 | N/A | 9.63 | N/A | 13.4 | N/A | 107 |